

61t BENCH TABLE



FLIP-UP BENCHES
Benches easily flip up over the tabletop for convenient cleaning under the table.



TABLE SHOWN 61T09293012

FEATURES & BENEFITS

- ▶ **DoubleGuard®** enables tables to be stored folded flat for compact storage. *Tables store in less space!* Meets and exceeds current UL anti-tipping safety standards. *Safety is first priority!*
- ▶ **Torsion Bars and Compression Springs** work together to provide long-lasting lift assistance. *One of the easiest lifting tables on the market.*
- ▶ **Center Legs** provide additional load-bearing capacity. *Holds up to the rigors of today's school environment.*
- ▶ **End Leg Assemblies** with center wheels offer superior weight distribution. Equipped with six ball bearing Poly II swivel casters. *Stronger, more durable tables.*
- ▶ **Poly II Caster Wheels** provide excellent floor protection, abrasion resistance, high impact strength, and easy, quiet operation. They are non-marking and resistant to water, oil and most chemicals. *Tables move with little effort on these long-lasting wheels.*
- ▶ **Center Latches** are accessible from either side of the table. *Saves time – less walking around tables.* Two-stage latches have safety stop and in use positions. *Allows easier set-up positioning and clean-up.*
- ▶ **Benches Flip** up for easy cleaning under the table. *No more moving tables out of the way for cleaning!*
- ▶ **Wheelchair-accessible Model** provides access for one wheelchair user for each bench removed. *Easy bench removal promotes inclusiveness in the student body.*
- ▶ **Door Clearance** is not a problem; our tables easily clear standard 7' door frames. *Tables can be easily moved throughout your building.*
- ▶ **EdgeGuard™** is a sprayed on polyurea edge treatment that provides superior resistance to moisture, eliminates unsanitary food traps, and is extremely tamper resistant. *Top edges stay sealed, preventing edges from peeling and chipping.*
- ▶ **Powdercoat Finish** creates a harder finish that is tougher and longer lasting than conventional paint. *Reduces chips, scratches and protects frames.*
- ▶ **Wilsonart® Laminates** are abrasion resistant and meet or exceed NEMA specifications. *Less scratching, fading and staining.*

TABLE CONFIGURATIONS

Model Number	Seating Capacity Children/Adults	Table & Seat Height	Storage Height
61T09273012	16/12	27"/15"	78"
61T09293012	16/12	29"/17"	80"
61T09303012*WC	12/9 + 1WC	30"/18"	81"

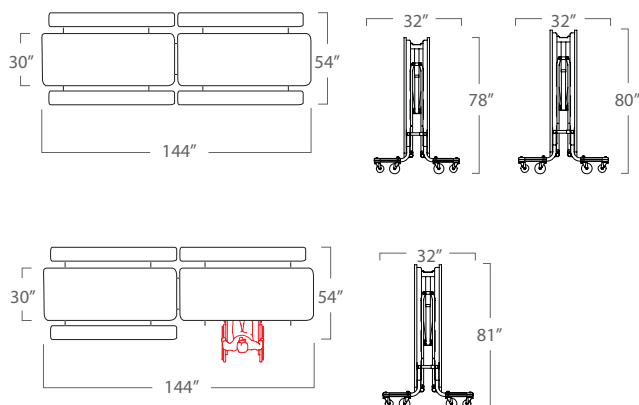

TORSION BARS & COMPRESSION SPRINGS

Provide one of the easiest lifting tables on the market.

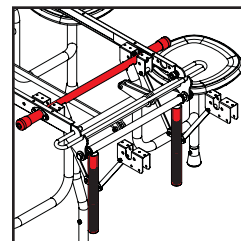

CENTER LATCHES

Two-stage latches have safety stop and in use positions for safe operation.

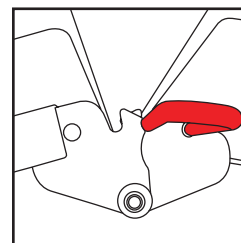

COMPACT STORAGE

Three tables require less than a 4.5' x 5.5' footprint. Additional tables add 15" to the nested depth.

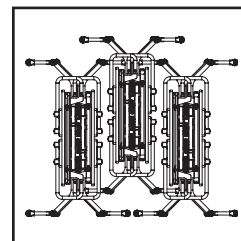

DOUBLEGUARD®

Prevents tip-over when tables are moved in storage position. Meets and exceeds current UL anti-tipping safety standards.

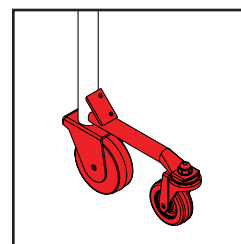

THIRD WHEEL & CENTER LEG

Provide superior weight distribution in open positions.

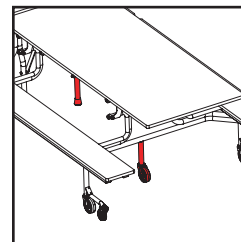

800-788-1028

For a complete listing of all our products, visit our website at palmerhamilton.com



As part of Palmer Hamilton's on-going commitment to quality, product specifications, changes, or modifications may be made without prior notice. **Warranty:** PALMER HAMILTON warrants that its products shall be free from defects in original material and workmanship for a period of fifteen years from the original shipment date. This warranty shall not apply to normal wear and tear or in the event products are damaged as a result of misuse, abuse, vandalism, neglect, accident, improper application, and modification or repair by persons not authorized by PALMER HAMILTON. The company will, at its discretion, repair or replace any defects. Any repair or replacement must be approved in advance by the factory before any action is taken. There are no implied warranties of fitness or merchantability, and there are no other express warranties beyond the warranties expressed here. Designated tables are UL listed, others may be UL pending, please inquire. 4/12/2011